

Classification	System and Application FAQ on XPAC				No.	1-009-01	
Author	Weikai	Version	1.0.0	Date	2011/3/31	Page	1/2

How to change the display type for XP-8000

Applies to:

Platform	OS version	WinPAC/ViewPAC utility version
XPAC series	All versions (WinCE6)	All versions

The default display resolution for XPAC is “1024*768” You can change the display type depending on your preferences.

Tips & Warnings

 If your monitor doesn't support the display mode that you set, the monitor may not display correctly.

To change the display mode for XPAC, perform the following steps:

Step 1: Change the display resolution using the XPAC utility.

1.1. Start the XPAC utility on the desktop.

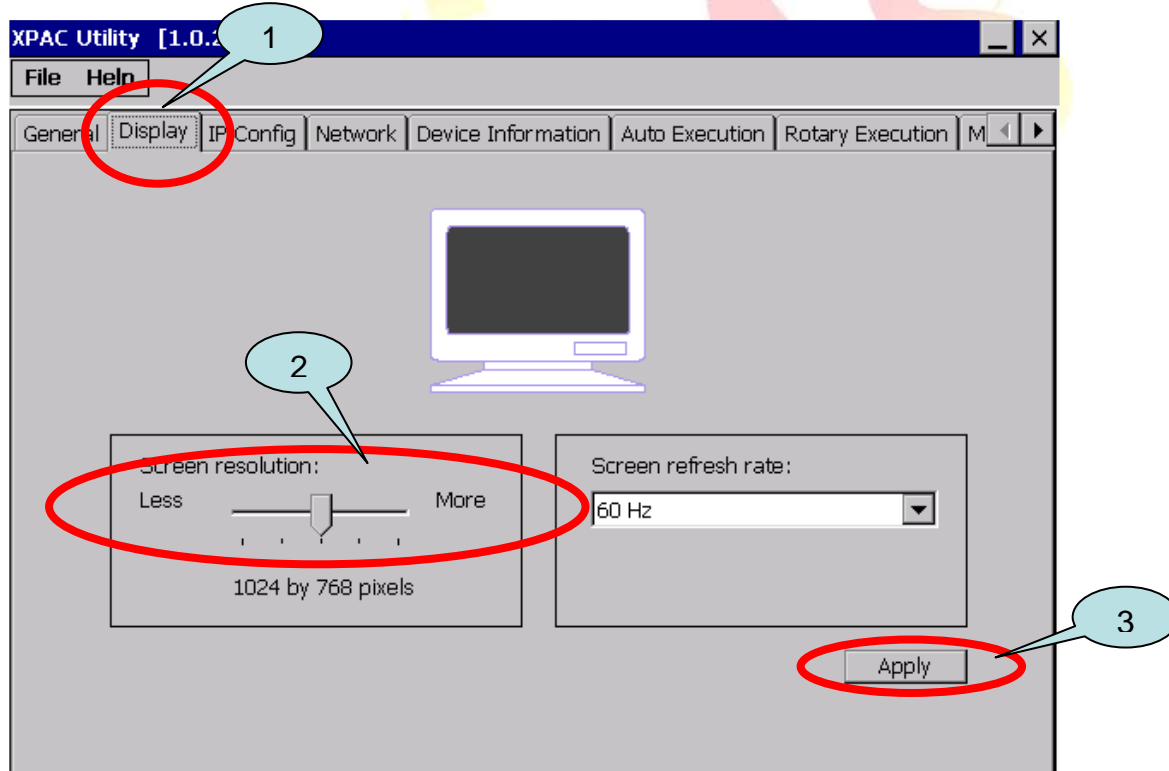

Step 2: Reboot your XPAC.

Classification	System and Application FAQ on XPAC				No.	1-009-01	
Author	WeiKai	Version	1.0.0	Date	2011/3/31	Page	2/2

Tips & Warnings

 If nothing was displayed on your monitor while booting, the display settings selected on the XPAC may not be supported by your monitor.

Please see the document “How to change the display type for XPAC when the display settings on current monitor out of range” for more details.

