



Feature	
■	32 Digital channels
■	Termination board break off detection
■	Redundant

DN-DIO-M

Universal termination board for digital I/O

Introduction

DN-DIO-M is a universal terminal board designed for digital I/O modules. It is small in size and has the same size as the common micro terminal boards on the market, making it easy to use.

Specifications

Digital input		Digital output	
Type	Wet contact (Current sinking / sourcing)	Type	Current sinking, Open-collector
Number of channels	32	Number of channels	32
General			
Dimensions	112 x 117 x 29mm (W x L x H)		
Mounting	35 mm DIN Rail, Wall		
Operating Temperature	-25 ~ 75 °C		
Humidity	5 ~ 95 % RH, Non-condensing		

Pin Assignment

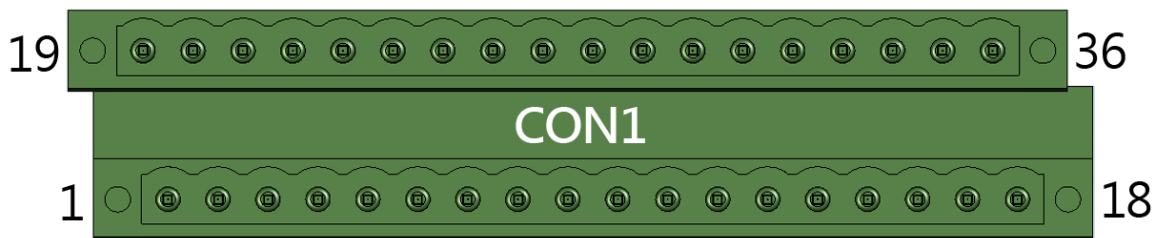

19	20	21	22	23	24	25	26	27	28	29	30	31	32	33	34	35	36
DI16	DI17	DI18	DI19	DI20	DI21	DI22	DI23	DI24	DI25	DI26	DI27	DI28	DI29	DI30	DI31	N/A	COM
DO16	DO17	DO18	DO19	DO20	DO21	DO22	DO23	DO24	DO25	DO26	DO27	DO28	DO29	DO30	DO31	GND	PWR
1	2	3	4	5	6	7	8	9	10	11	12	13	14	15	16	17	18
DI0	DI1	DI2	DI3	DI4	DI5	DI6	DI7	DI8	DI9	DI10	DI11	DI12	DI13	DI14	DI15	N/A	COM
DO0	DO1	DO2	DO3	DO4	DO5	DO6	DO7	DO8	DO9	DO10	DO11	DO12	DO13	DO14	DO15	GND	PWR

Wire Connections

Digital input

Input Type	ON State LED ON Readback as 0	OFF State LED OFF Readback as 1
Relay Contact	Relay ON 	Relay Off
TTL/CMOS Logic	Voltage > 3.5V 	Voltage < 1V
NPN Output	Open Collector On 	Open Collector Off
PNP Output	Open Collector On 	Open Collector Off

Digital output

Output Type	ON State LED ON Readback as 1	OFF State LED OFF Readback as 0
Drive Relay	Relay ON 	Relay Off
Resistance Load		

Dimension (unit: mm)

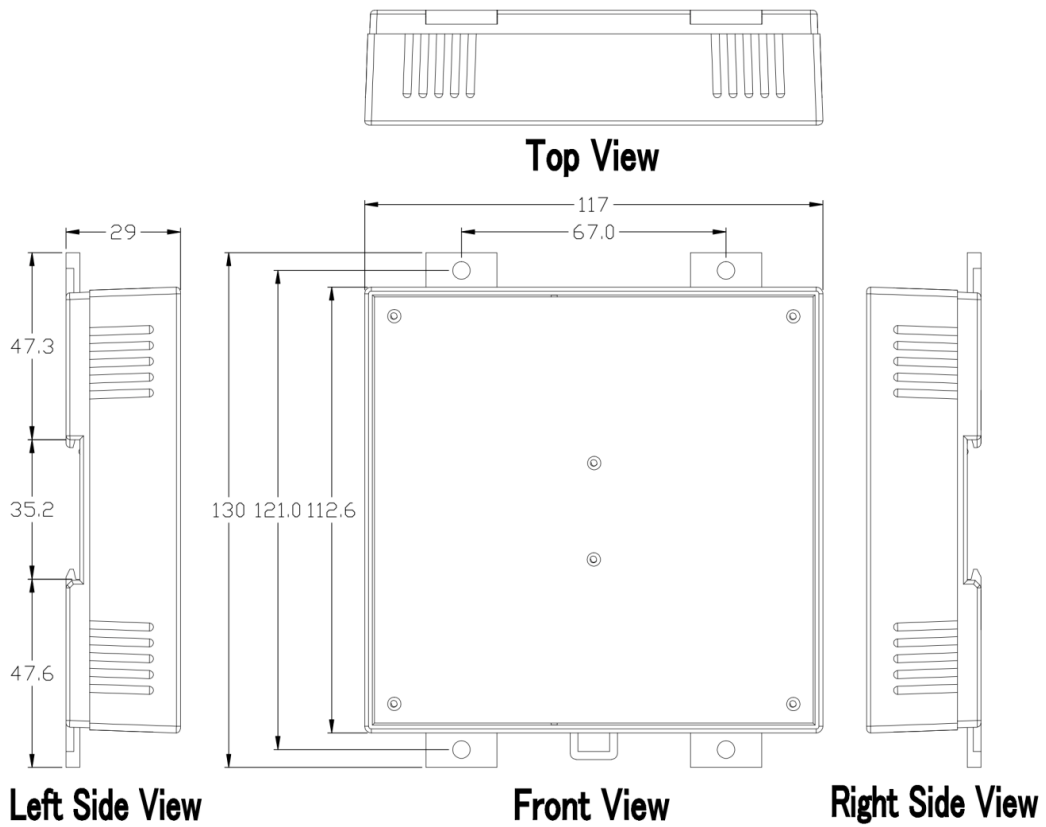

Unit: mm



Bottom View

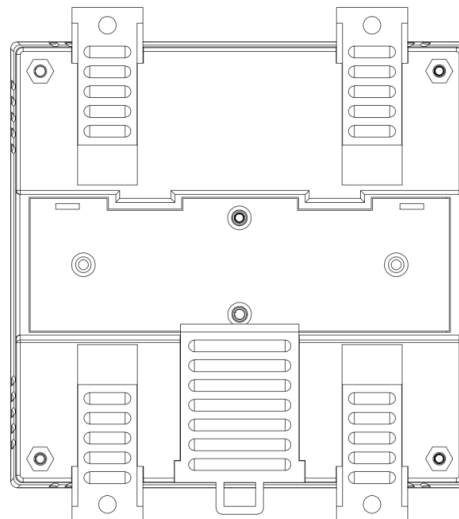

Rear View

Ordering Information

DN-DIO-M CR	Universal termination board for digital I/O (RoHS)
-------------	--